

# KCIS71DMNU9

62225-11056908

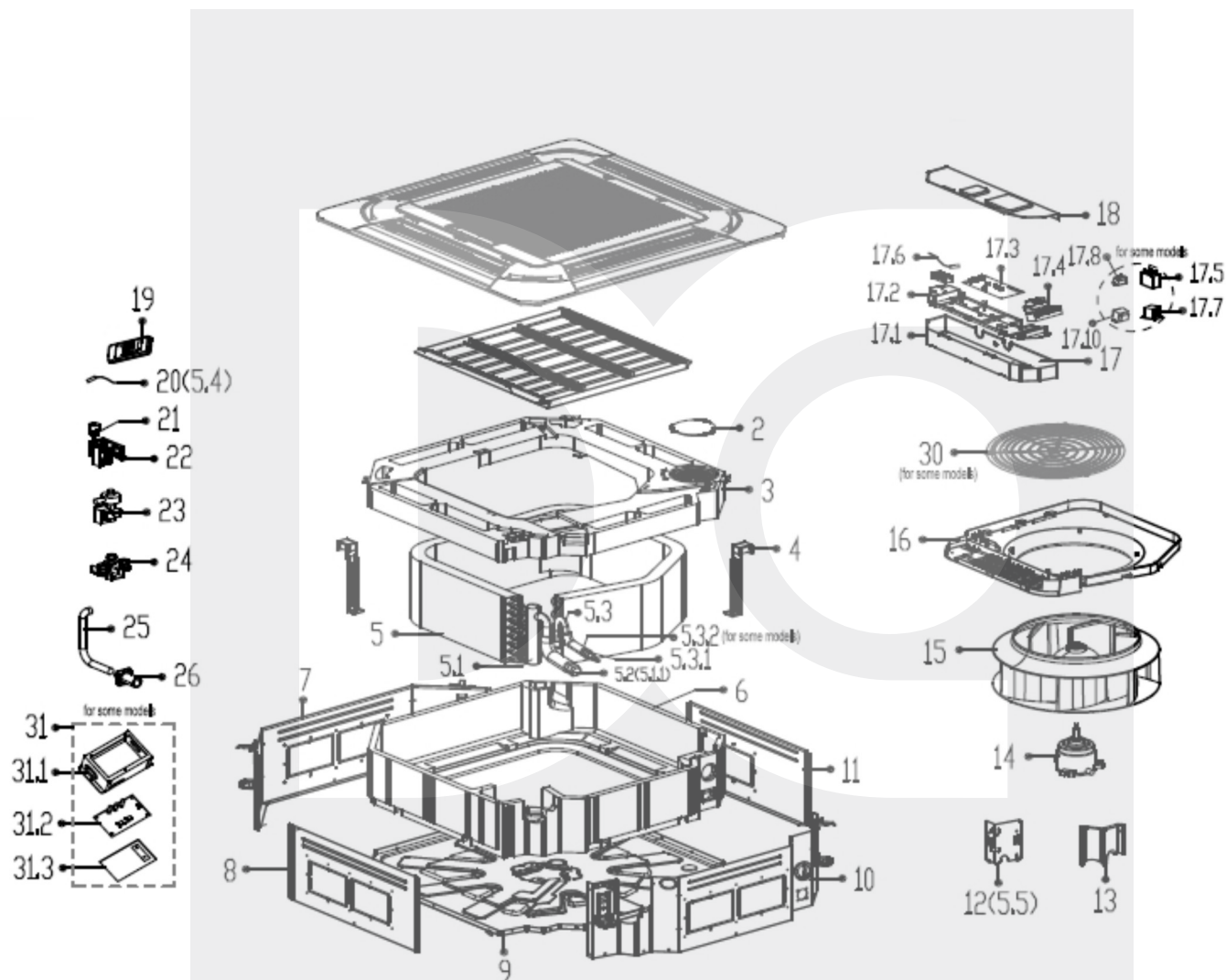

# THERMO COMFORT

**Sale Model :**

**Factory Model :**

**Product Name :**

**Power Supply :**

MCD-24HRFN1-QRC8W(D)

EU-KFR71Q4/BP3N1Y-DD(RC8)-W

62225-11056908

220\_240V\_1Ph,FREQUENCY\_50HZ

Positie	Omschrijving	Code Engels	Leveranciersnummer	Extra info
2	Cover		12122500000025	
3	Foam tray assembly for condenser water		12822500000059	
4	Evaporator fixing hanger		12222500000092	
5	Evaporator assembly		15822500000679	
5.1	Output pipe assembly		15122500000203	
5.2	Copper nut		15500406000003	TLM-D04
5.3	Input pipe assembly		15122500000298	
5.3.1	Copper nut		15500406000010	TLM-B02
6	Base foam assembly		12822500000015	
7	Board assembly III		12222500000144	
8	Board assembly I		12222500000230	
9	Chassis assembly		12222500000122	
10	Board assembly II		12222500000137	
11	Board assembly cō		12222500000241	
12	Evaporator fixing board		12222500000105	
13	Pipe fixing board assembly		12122500000331	
14	Asynchronous motor		11002015000281	ZKFP-124-8-2
15	Fan assembly		12100103000096	LX-476*160*12-7JN
16	Ventilation assembly		12122500000420	
17	Electronic control box assembly		17222500A01577	
17.1	Electronic control box		12222500000119	
17.2	Insulation plate		12122500000029	
17.3	Main control board assembly		17122500A01189	EU-KFR71Q4/BP3N1Y-DD(RC8)-W.JD.Q.NK.NK2.3
17.4	Wire joint		17400401000068	JXZ-PG6HG6-A(YF2004A)
17.6	Ambient temperature sensor assembly		11201007000283	CGQ-WD/SW4100-L150-SMP2-P110
17.7	Reactance		17400306000070	R05094A
18	Cover of electronic control box I		12222500000162	
20	Pipe temperature sensor		11201007000136	CGQ-WD/GW4100-L850-SMP3B-P800
21	Water level sensor assembly		11201005000006	
22	Water Pump installation bracket assembly		12222500001012	

23	Drain pump		17400802000012	
24	Pump rubber washer		12622500000006	
25	Drain pipe		12622500000013	
26	Water pipe		12100509000068	

Sale	MCD-24HRFN1-QRC8W(D)
Factory	EU-KFR71Q4/BP3N1Y-DD(RC8)-W
Product	62225-11056908

THERMO COMFORT